

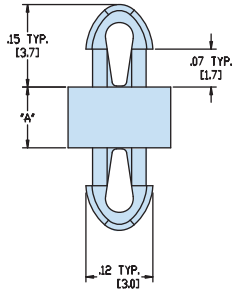

Heyco® Nylon PCB Supports - Metric Spacing



TEARDROP SNAP LOCK /
TEARDROP SNAP LOCK

HSP-MDL-1

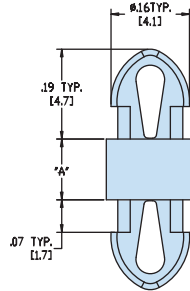

TEARDROP SNAP LOCK /
TEARDROP SNAP LOCK

HSP-MDL-2

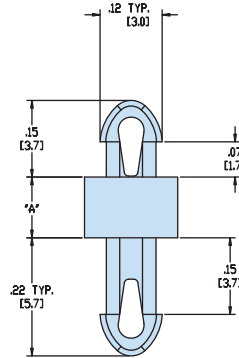

TEARDROP SNAP LOCK /
TEARDROP SNAP LOCK

HSP-MDLS-1

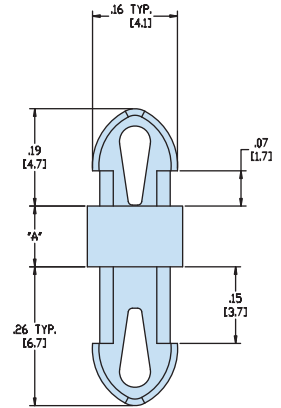

TEARDROP SNAP LOCK /
TEARDROP SNAP LOCK

HSP-MDLS-2

| | Maximum Thickness | | Mounting Hole Diameter | | Maximum Thickness | | Mounting Hole Diameter | | Maximum Thickness | | Mounting Hole Diameter | | Maximum Thickness | | Mounting Hole Diameter | |
|----------------|-------------------|-----|------------------------|-----|-------------------|-----|------------------------|-----|-------------------|-----|------------------------|-----|-------------------|-----|------------------------|-----|
| | in. | mm. | in. | mm. | in. | mm. | in. | mm. | in. | mm. | in. | mm. | in. | mm. | in. | mm. |
| PCB | .062 | 1,6 | .098 | 2,5 | .062 | 1,6 | .137 | 3,5 | .062 | 1,6 | .098 | 2,5 | .062 | 1,6 | .137 | 3,5 |
| Chassis | .062 | 1,6 | .098 | 2,5 | .062 | 1,6 | .137 | 3,5 | .141 | 3,6 | .098 | 2,5 | .141 | 3,6 | .137 | 3,5 |

| A mm. | PART NO. Natural | DESCRIPTION | PART NO. Natural | DESCRIPTION | PART NO. Natural | DESCRIPTION | PART NO. Natural | DESCRIPTION |
|----------|---------------------|-----------------|---------------------|-----------------|---------------------|----------------|---------------------|----------------|
| 2,0 | 10444 | HSP-MDL-1-02M | 10461 | HSP-MDL-2-02M | 10478 | HSP-MDLS-1-02M | 10493 | HSP-MDLS-2-02M |
| 3,0 | 10445 | HSP-MDL-1-03M | 10462 | HSP-MDL-2-03M | 10479 | HSP-MDLS-1-03M | 10494 | HSP-MDLS-2-03M |
| 4,0 | 10446 | HSP-MDL-1-04M | 10463 | HSP-MDL-2-04M | 10480 | HSP-MDLS-1-04M | 10495 | HSP-MDLS-2-04M |
| 5,0 | 10447 | HSP-MDL-1-05M | 10464 | HSP-MDL-2-05M | 10481 | HSP-MDLS-1-05M | 10496 | HSP-MDLS-2-05M |
| 6,0 | 10448 | HSP-MDL-1-06M | 10465 | HSP-MDL-2-06M | 10482 | HSP-MDLS-1-06M | 10497 | HSP-MDLS-2-06M |
| 7,0 | 10449 | HSP-MDL-1-07M | 10466 | HSP-MDL-2-07M | 10483 | HSP-MDLS-1-07M | 10498 | HSP-MDLS-2-07M |
| 8,0 | 10450 | HSP-MDL-1-08M | 10467 | HSP-MDL-2-08M | 10484 | HSP-MDLS-1-08M | 10499 | HSP-MDLS-2-08M |
| 9,0 | 10451 | HSP-MDL-1-09M | 10468 | HSP-MDL-2-09M | | | | |
| 10,0 | 10452 | HSP-MDL-1-10M | 10469 | HSP-MDL-2-10M | 10485 | HSP-MDLS-1-10M | 10500 | HSP-MDLS-2-10M |
| 12,0 | 10453 | HSP-MDL-1-12M | 10470 | HSP-MDL-2-12M | 10486 | HSP-MDLS-1-12M | 10501 | HSP-MDLS-2-12M |
| 14,0 | 10454 | HSP-MDL-1-14M | 10471 | HSP-MDL-2-14M | 10487 | HSP-MDLS-1-14M | 10502 | HSP-MDLS-2-14M |
| 16,0 | 10455 | HSP-MDL-1-16M | 10472 | HSP-MDL-2-16M | 10488 | HSP-MDLS-1-16M | 10503 | HSP-MDLS-2-16M |
| 18,0 | 10456 | HSP-MDL-1-18M | 10473 | HSP-MDL-2-18M | 10489 | HSP-MDLS-1-18M | 10504 | HSP-MDLS-2-18M |
| 20,0 | 10457 | HSP-MDL-1-20M | 10474 | HSP-MDL-2-20M | 10490 | HSP-MDLS-1-20M | 10505 | HSP-MDLS-2-20M |
| 22,0 | 10458 | HSP-MDL-1-22M | 10475 | HSP-MDL-2-22M | 10491 | HSP-MDLS-1-22M | 10506 | HSP-MDLS-2-22M |
| 26,5 | 10459 | HSP-MDL-1-26.5M | 10476 | HSP-MDL-2-26.5M | | | | |

Standard color natural. For special order parts in UL 94V-0 natural material, add the suffix "F" to Part No.

*Quick
Specs*

Material Nylon 6/6
 Flammability Rating 94V-2
 Temperature Range .4°F (-18°C) to 185°F (85°C)